

WDV2 Demand Drain

 = "Most Popular"

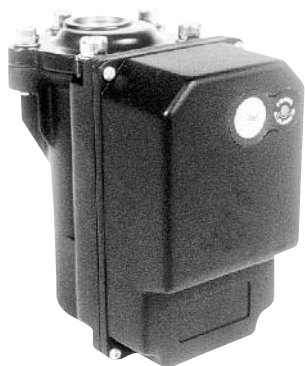

WDV2-425

Features

- Zero Air Loss
- Automatically Self-Adjusting for Voltages from 24 to 230V AC/DC
- Sensor Device with No Moving Parts
- Sophisticated Electronic Controls
- Alarm with Remote Contacts
- Large Inlet Port to Eliminate Clogging
- Manual Push-to-Test Button
- Automatically Clears Slugs

Benefits

- Energy Efficient
- World-Wide Applications
- Long Life
- High Reliability
- Versatility, Early Warning
- Low Maintenance
- On Demand Operation
- Maintenance Free

The WDV2 Electronic Demand Drain Valves, with zero air loss, are suitable for all compressed air system applications from aftercoolers to filters to receivers to refrigerated dryers. These drain valves activate automatically and are both reliable and economical.

Condensate (water, oil, and dirt) collect in the sump while the diaphragm is held closed by system pressure. As soon as the top sensor detects liquid, the solenoid energizes. The chamber above the diaphragm deflates and the condensate is driven out by system pressure. A timer is activated which allows a specific amount of condensate out and closes before any air is lost. If the unit gets clogged with a slug of condensate and scale, it will pulse to push that slug out of the valve and allow it to continue working properly. If the slug can not be removed after a set period of time, an alarm light and contact will signal a problem.

Specifications: WDV2-E

Voltage	24 to 240V AC/DC, 50/60 Hz
Drain Volume	0.01 gallons/cycle
Maximum Fluid Temperature	150°F (60°C)

Operating Conditions

Maximum Operating Pressure	232 PSIG (16 bar)
Ambient Temperature	33° to 140°F (0° to 60°C)

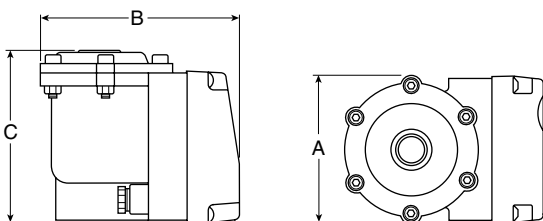

Dimensions

Models	Inches (mm)	A	B	C
Standard Unit WDV2-EX		3.5 (89)	5.0 (127)	5.0 (127)

Automatic Electrical Drain Valve WDV3-G

= "Most Popular"

The Wilkerson Electrical Drain is designed to automatically drain large amounts of collected water, while minimizing air loss from compressed air systems. This drain is ideally suited to draining separators, receivers, refrigerated dryers, filters and drop legs.



WDV3-G

The Wilkerson Automatic Electrical Drain guards against damage by liquid carryover. The unit discharges up to 20 GPM at 100 PSIG. This normally closed valve is designed with a non-clogging full-port drain orifice to provide reliable draining and minimal routine servicing.

The dual timing features of 30 seconds to 45 minutes cycle time and 1/2 to 10 seconds valve open time permit adjustments over a wide range of applications. Simply adjust the cycle time interval and the valve open time to meet your specific requirements. The Automatic Electrical Drain eliminates manual draining of accumulated water in a compressed air system. The two indicator lights, for indicating power on and valve open status, simplify installation and make visual checks easy.

Protection of the solid state controls is provided by a NEMA 4 enclosure, which isolates the components from moisture and dust. Each model is provided with a heavy-duty, six-foot-long, three-wire grounded power cord for easy installation.

Specifications

Operating Pressure (-L Models)	230 PSIG (15,9 bar)	
Ambient Operating Range Temperature	33° to 130°F (0,1° to 54°C)	
Coil Insulation	Class H	340°F (171,1°C)
Voltages	AC	115, 230/50-60
	DC	24
Timer	Open Time	1/2 to 10 sec., Adjustable
	Cycle Time	30 sec. to 45 min., Adjustable
Maximum Current Rating	4mA Max.	
Port Size	NPT	1/4, 3/8, 1/2
Weight	lb. (kg)	1.8 (0,8)

Materials of Construction

Valve Body	Brass / Stainless Steel	
Enclosure	NEMA 4	ABS Plastic
Internal Parts	Brass / Stainless Steel	
Sealing Material	NBR, FKM, EPDM	

Ordering Information

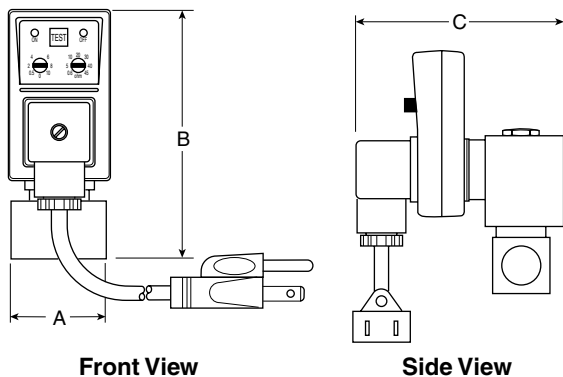
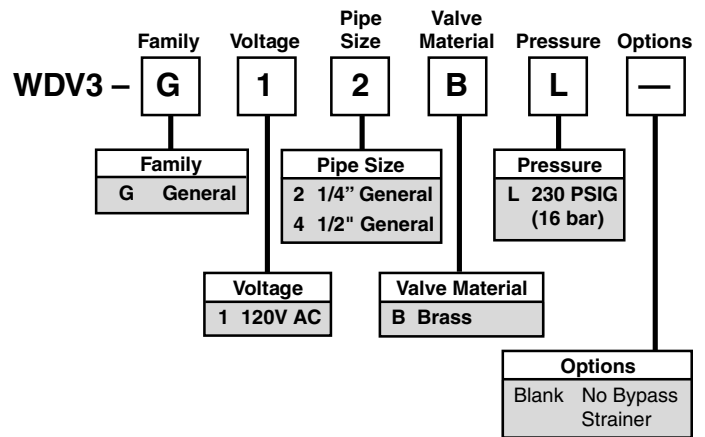

Dimensions

Models	Inches (mm)	A	B	C
Standard Unit WDV3-G-02-XXX		1.62 (41)	4.33 (110)	3.54 (90)

Motorized Ball Valve Drain WDV4

= "Most Popular"

When pipe scale, contaminants from deliquescent dryers or other large particles present in your condensate keep plugging or holding open your common drain valve, it's time for the WDV4 motorized ball drain valve from Wilkerson. This valve is or sticking open. It consists of a 1/2" full-flow ball valve with an electric timer / motor. The internal timer is adjustable from 4 minutes to 24 hours, and the valve will perform one full rotation in 7.5 seconds. Battery backup will provide continued operation in the event of a power failure.



WDV4

Features

- Designed for Heavy-Duty Applications
- High Pressure Capabilities
- Microprocessor-Based Electronics
- Weatherproof Enclosure
- Battery Backup Protection Against Power Failure (Not Available on Competitors' Units)
- Double O-ring Seal on Valve Shaft vs. Competitors with Only One O-ring Seal
- Corrosion Resistant Valve Coating
- 10 Programmable Settings From 4 Minutes to 24 Hours vs. Competitor's Dip Switch Selections from 6 to 10 Hours
- Manual Test Button
- Valve Open and Program Indicator
- Anti-Blockage System to Protect Motor

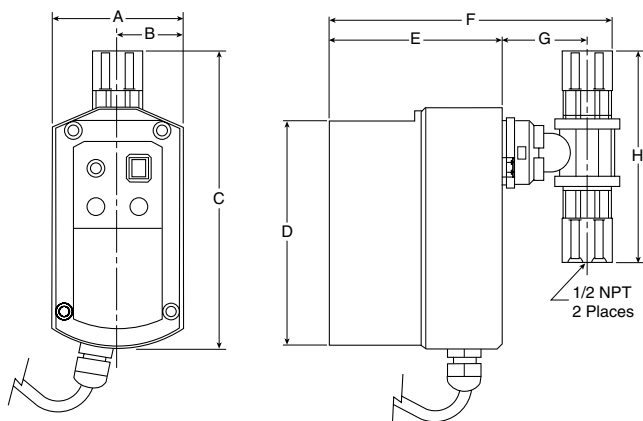

Dimensions

Models	Inches (mm)	A	B	C	D	E	F	G	H
Standard Unit WDV4-X		2.9 (74)	1.4 (35)	6.5 (165)	5.0 (127)	3.7 (94)	6.3 (160)	1.9 (48)	4.6 (119)

Specifications

Cycle Time	4 minutes - 24 hours
On Time	7.5 seconds
Programmed Settings	10
Valve	Nickel-Plated Brass with Stainless Steel Ball
Connections	1/2" NPT
Valve Sealing	Fluorocarbon O-rings with PTFE Seal
Voltage	115/230V AC 50/60 Hz
Enclosure	Non-Corrosive Plastic

Operating Conditions

Maximum Operating Pressure	230 PSIG (16 bar)
Ambient Temperature	33° to 122°F (0° to 50°C)

Benefits

- Reliable — Long life
- Versatile Applications
- High Reliability
- Indoor / Outdoor Operation
- Continuous Operation
- No Leak of Condensate into Electronics
- Can be Used in Harsh Environments Like Deliquescent Dryers
- Versatility
- On-Demand Operation
- Visual Indication of Operation
- Motor Will Not Burn Out, Even Under Adverse Conditions